

## SECTION XI

### MAINTENANCE PARTS CATALOG

**Introduction**

The primary purpose of this Maintenance Parts Catalog is to make easy the ordering of parts which may be required for the maintenance of the Hamilton Ship Chronometer. Such maintenance parts are under the cognizance of the Ships Parts Control Center, Mechanicsburg, Pa.

This catalog comprises a Group Assembly Parts List detailing all main assemblies, sub-assemblies, component parts and attaching parts; a series of exploded views illustrating the Group Assembly Parts List; and a Numerical Parts List. These are described in subsequent paragraphs.

(continued on page 80)

#### GROUP ASSEMBLY PARTS LIST

Figure and Index Number	SPCC-MFR Number	Hamilton Part Number	Part Name						Units Per Assy.
			1	2	3	4	5	6	
	F.S.S.C. 18-C-815	42301	Ship Chronometer Assembly						1
	F.S.S.C. 18-C-815	+42213	Ship Chronometer Assembly						Ref.
	F.S.S.C. 18-C-815	+42212	Ship Chronometer Assembly						Ref.
106-1	H18-HM-10002	+42202	Case - Carrying, complete						Ref.
106-2	H18-HM-10003	+42130	Case - Carrying, complete						Ref.
	H18-HM-10004	42297	Mounting Box and Gimbal Assembly						1
106-3	H18-HM-10005	42201	Box - Mounting, complete						1
106-4	H18-HM-10006	+42129	Box - Mounting, complete						Ref.
106-5	H18-HM-10007	42044	Key - Winding, complete						1
	H18-HM-10008	42100A	Gimbal Assembly						1
106-6	H18-HM-10009	42106	Ring - Gimbal, complete with bushing						1
106-7	H18-HM-10010	42214	Bushing - Pivot screw						1
106-8	H18-HM-10011	42107	Strap - Gimbal support, complete with bushing						1
106-9	H18-HM-10012	42116	Screw - Gimbal support strap						2
106-7	H18-HM-10010	42214	Bushing - Pivot screw						1
106-10	H18-HM-10013	42108	Strap - Case support						1
106-9	H18-HM-10012	42116	Screw - Case support strap						2
106-11	H18-HM-10014	42118	Screw - Case rear pivot						1
106-12	H18-HM-10015	42121	Nut - Pivot screw lock						1
106-13	H18-HM-10016	42119	Screw - Case front pivot						1
106-12	H18-HM-10015	42121	Nut - Pivot screw lock						1
106-14	H18-HM-10017	42120	Screw - Gimbal ring pivot						2
106-15	H18-HM-10018	42122	Washer - Gimbal ring pivot screw						2
106-12	H18-HM-10015	42121	Nut - Pivot screw lock						2
106-16	H18-HM-10019	42109	Bracket - Latch support						1
106-17	H18-HM-10020	42110	Bracket - Latch clamping						1
106-18	H18-HM-10021	42123	Washer - Latch support bracket screw						2
106-19	H18-HM-10022	42115	Screw - Latch support bracket						2
106-20	H18-HM-10023	42111	Lever - Latch						1
106-21	H18-HM-10024	42277	Spring - Latch lever take-up						1
106-22	H18-HM-10025	42276	Screw - Latch lever take-up spring						2
106-23	H18-HM-10026	42114	Screw - Latch clamping						1
106-24	H18-HM-10027	42112	Handle - Latch lever						1
106-25	H18-HM-10028	42298	Case and Movement Assembly						1

+See note on page 88.

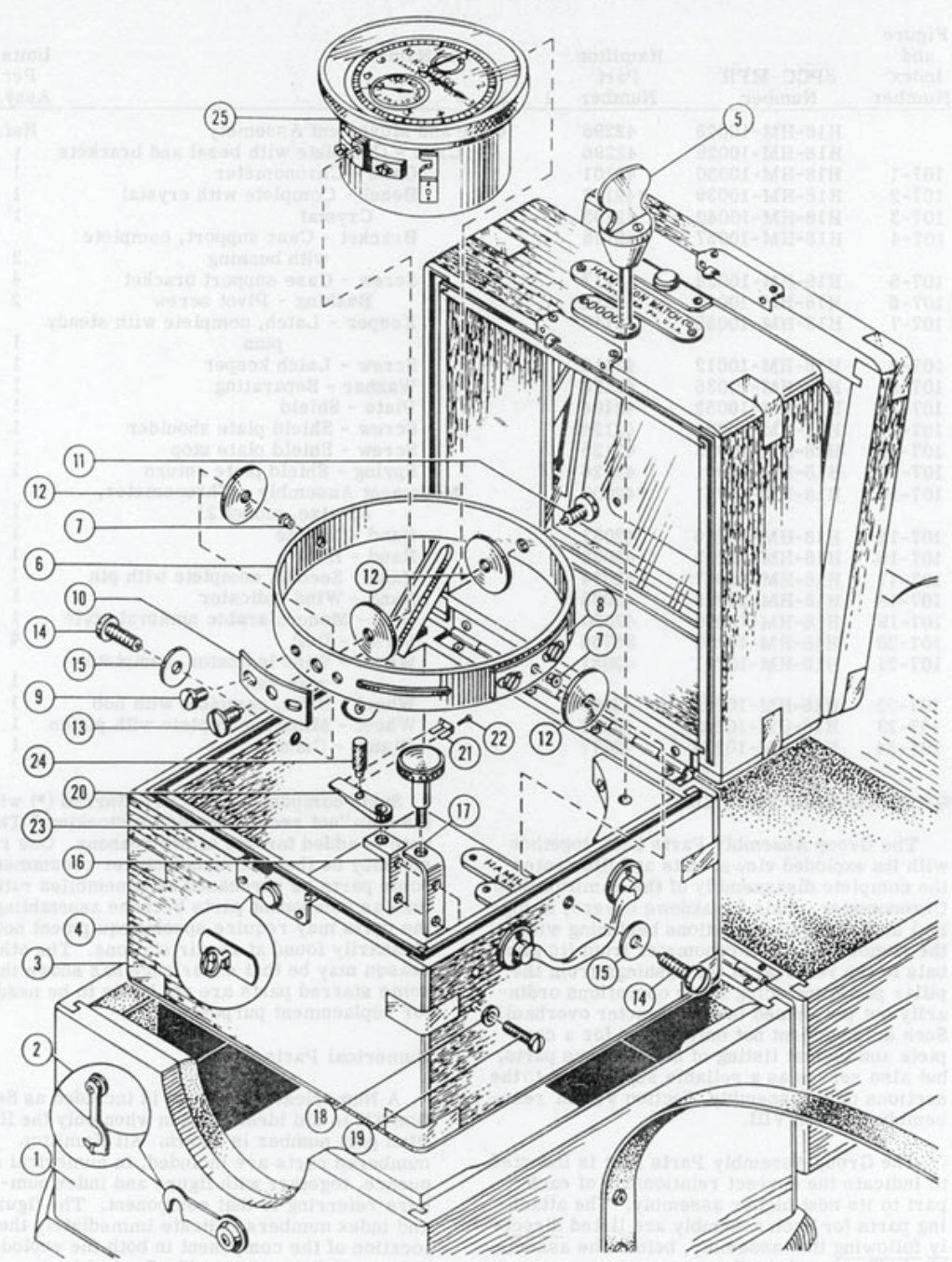

Figure 106