

GROUP ASSEMBLY PARTS LIST

Figure and Index Number	SPCC-MFR Number	Hamilton Part Number	Part Name						Units Per Assy.
			1	2	3	4	5	6	
	H18-HM-10028	42298	Case and Movement Assembly						Ref.
	H18-HM-10029	42296	Case - Complete with bezel and brackets						1
107-1	H18-HM-10030	42101	Case - Chronometer						1
107-2	H18-HM-10039	*42102	Bezel - Complete with crystal						1
107-3	H18-HM-10040	42103	Crystal						1
107-4	H18-HM-10037	42105	Bracket - Case support, complete with bushing						2
107-5	H18-HM-10038	42117	Screw - Case support bracket						4
107-6	H18-HM-10010	42214	Bushing - Pivot screw						2
107-7	H18-HM-10035	42113	Keeper - Latch, complete with steady pins						1
107-8	H18-HM-10012	42116	Screw - Latch keeper						1
107-9	H18-HM-10036	42128	Washer - Separating						1
107-10	H18-HM-10032	42104	Plate - Shield						1
107-11	H18-HM-10034	42124	Screw - Shield plate shoulder						1
107-12	H18-HM-10033	42125	Screw - Shield plate stop						1
107-13	H18-HM-10031	42126	Spring - Shield plate return						1
107-14	H18-HM-10041	*42000	Movement Assembly - Chronometer, 85-size, model 21						1
107-15	H18-HM-10216	42033	Hand - Minute						1
107-16	H18-HM-10215	42032	Hand - Hour						1
107-17	H18-HM-10217	42034	Hand - Second, complete with pin						1
107-18	H18-HM-10218	42035	Hand - Wind indicator						1
107-19	H18-HM-10219	42030	Dial - Modern arabic numeral style						1
107-20	H18-HM-10220	35756	Screw - Dial						4
107-21	H18-HM-10221	42081	Wheel - Wind indicator, complete with hub						1
107-22	H18-HM-10222	42080	Wheel - Hour, complete with hub						1
107-23	H18-HM-10223	42078	Wheel - Minute, complete with pinion						1
107-24	H18-HM-10224	42077	Pinion - Cannon						1

Group Assembly Parts List

The Group Assembly Parts List, together with its exploded views, lists and illustrates the complete disassembly of the Hamilton Ship Chronometer. This breakdown covers, in logical sequence, all operations beginning with the removal of the chronometer from its gimbals to the removal of the bushings from the pillar plate, including some operations ordinarily not performed in chronometer overhaul. Such arrangement not only allows for a complete and logical listing of maintenance parts, but also serves as a reliable supplement to the sections on disassembly, Section V, and reassembly, Section VIII.

The Group Assembly Parts List is indented to indicate the correct relationship of each part to its next higher assembly. The attaching parts for each assembly are listed directly following that assembly, before the assembly is "broken down."

Some component parts are starred (\*) with the note "not recommended for stocking." This note is added for one of two reasons. One reason may be that the manufacturer recommends some parts be purchased as assemblies rather than as component parts because assembling the parts may require special equipment not ordinarily found at repair stations. The other reason may be that experience has shown that some starred parts are not likely to be needed for replacement purposes.

Numerical Parts List

A Numerical Parts List is included as Section XII to aid identification when only the Hamilton part number is known. All Hamilton numbered parts are included, in numerical sequence, together with figure and index numbers referring to that component. The figure and index numbers indicate immediately the location of the component in both the exploded views and Group Assembly Parts List.

\*Not recommended for stocking.

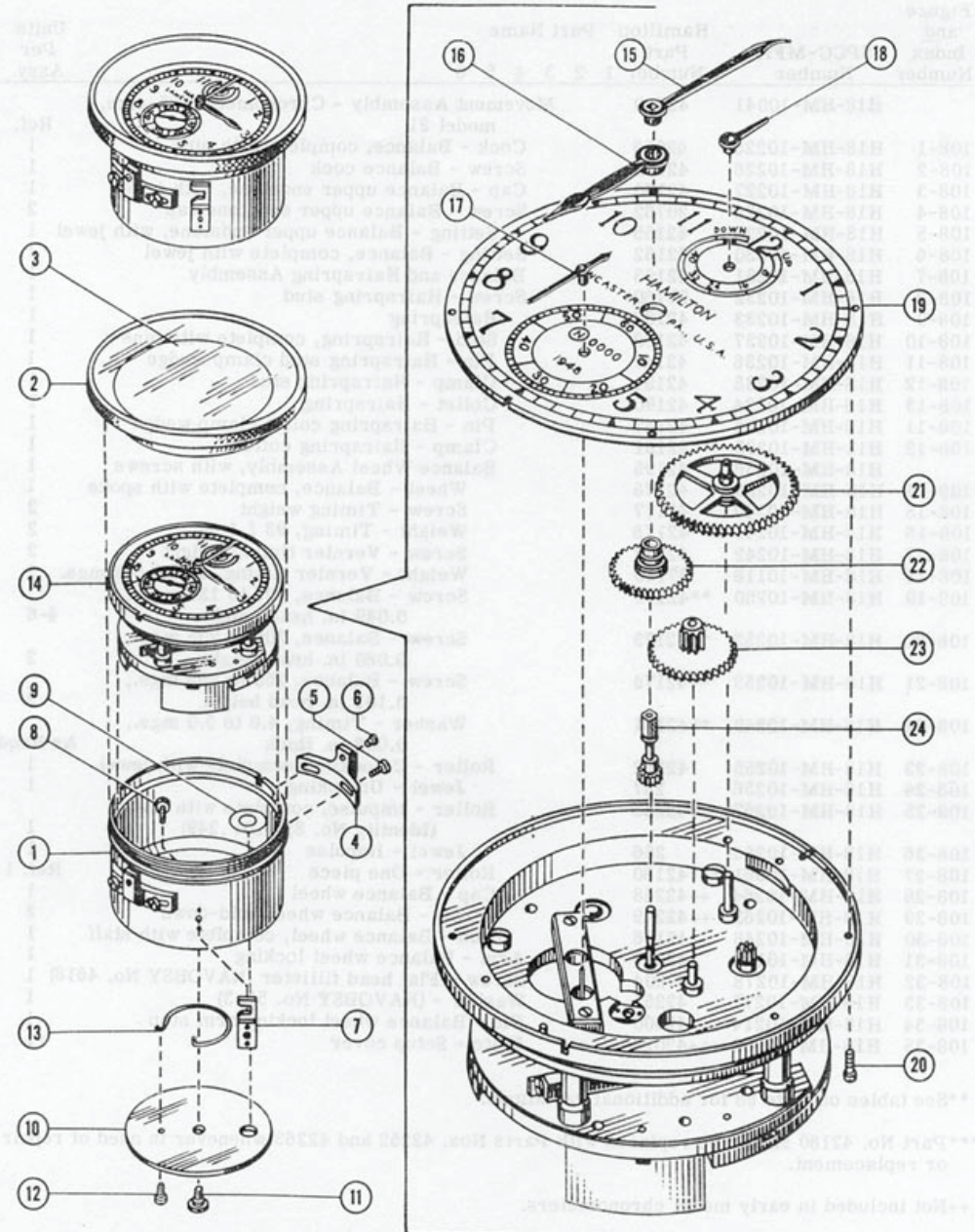

Figure 107